

ELEVATION  
1:20

SECTION  
1:20

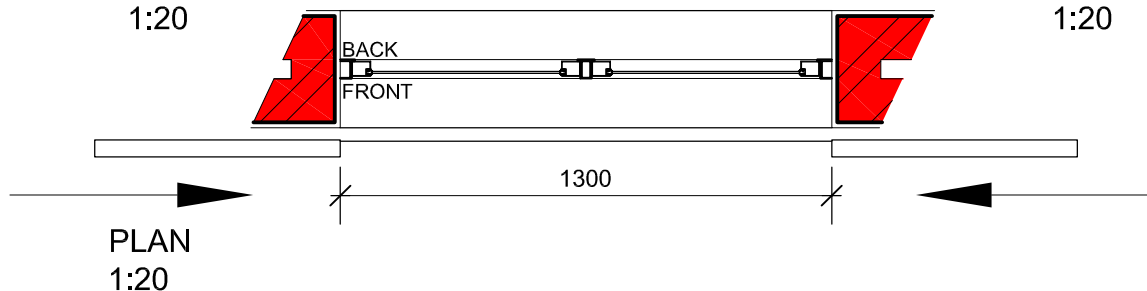
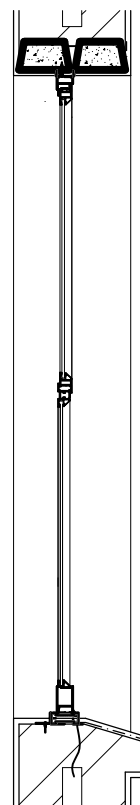

PLAN  
1:20

REF NUMBER	TYPE A
QUANTITY	13
LOCATION	W02, W06, W07, W19, W20, W21, W25, W13, W14, W15, W16, W17, W18
REVEAL	AS INDICATED ON PLAN
FINISH	Aluminium frame with four sliding sections
GLAZING	6.38mm double safety Glazing as per X.A calculations for SANS compliance.
FUNITURE	AS PER MANUFACTURER'S SPEC.
	ALL DIMENSIONS TO BE CHECKED ON SITE PRIOR TO MANUFACTURE

RENNIE SCURR ADENDORFF  
ARCHITECTS

15 New Church Street, Cape Town, 8001  
P O Box 16390 Vlaeberg 8018  
Tel (021) 423 0328 : Fax (021) 424 9396  
e-mail : cape@archrsa.com website : www.archrsa.com  
Copyright © (2007) Rennie Scurr Adendorff Architects.  
All rights reserved

Window Type A

DRAWING

PROJECT : New Office for South African Environmental  
Observation Network  
CLIENT : **National Research Foundation**

01544

PROJECT NO.

AON

DRAWN

W-6200

DRAWING

2019-09-17

DATE

A

REV

1:20

SCALE